



Deployment Guide & User Manual

1	What's Included
2	Deployment Steps
3	After Use Maintenance
4	Storage
5	Troubleshooting / FAQ
6	General Information
7	Product Warranty

This Deployment Guide & User Manual contains all the necessary information to correctly install, remove, maintain and store your Floodgate® flood barrier.

Your Floodgate flood barrier is a manually operated, reusable, demountable flood protection product designed for the temporary mitigation of flood risk and should be seen as part of a suite of measures to reduce the risk of flood water entering a property. It is not intended for installations providing permanent flood protection.

DEFINITION OF SYMBOLS



**CORRECT/
DO**



**INCORRECT/
DON'T**



**CAUTION/
IMPORTANT**

What's Included

1



x1 Floodgate
Flood Barrier



x1 Black Cover



x1 Ratchet Spanner



x1 Fitting Instructions



Important Information

- A flood protection risk assessment should be carried out by a suitably qualified professional prior to installation of the product to ensure the relevant routes for water entry have been identified and that the structural integrity of the building is not compromised by the product.
- The safety advice given by the emergency services should always be adhered to during flood conditions.



To help achieve an effective seal, walls need to be plumb, parallel with one another and at right angles to a level step/ground. Walls need to be sufficiently strong to cope with the lateral pressure exerted by the barrier.



Contact surfaces should be smooth, even and in good condition.

Floodgate's rubber cover is designed to work with surfaces such as brick, as long as the pointing is flush.

A minimum clear depth of reveal of 40mm is recommended.

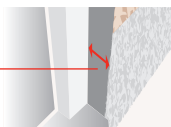

Rough, uneven surfaces can damage the cover.



If you are not sure the contact surfaces can withstand the pressures being exerted you MUST seek advice from a qualified professional.

Prior to deploying, remove any packaging from the cover and ensure the steel frame is fully closed. Carefully place the cover over all four edges of the frame (see diagram).



Avoid lifting the barrier by its cover and/or dragging along the ground.



Metal finishing on this product can be sharp. Suitable gloved protection should be worn whenever handling and operating the product.



When operating the unit ensure all limbs, loose garments and other personal accessories are kept clear of the moving parts.



This product should only be installed by a responsible adult.



Floodgate units can be heavy - please take care when lifting.



STEP 1

Ensure the entrance is clear of dirt and debris.



Debris can perforate the cover and undermine the integrity of an effective seal.

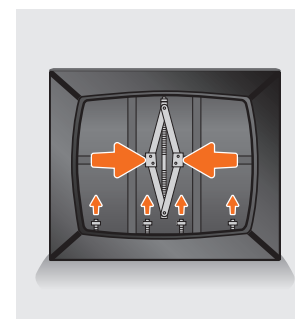

STEP 2

In preparation for positioning your Floodgate, ensure the central scissor jack on the rear of the Floodgate has been retracted to its closed position and the 4 downward pressure bolts have been fully loosened.



STEP 3

Standing behind the Floodgate, position it with its front facing towards the flood threat, and its rear vertical edges in contact with the door frame.

STEP 4

Keeping the barrier in a vertical position, use the supplied 17mm spanner to turn the bolt situated at the top of the scissor jack with a clockwise action, expanding the barrier horizontally into the walls of the reveal.

Once sufficient pressure is applied, the Floodgate will resist any attempt to manually move from its position.



Ensure the corners of the cover are positioned into the corners of the frame when expanding to achieve a uniform expansion.

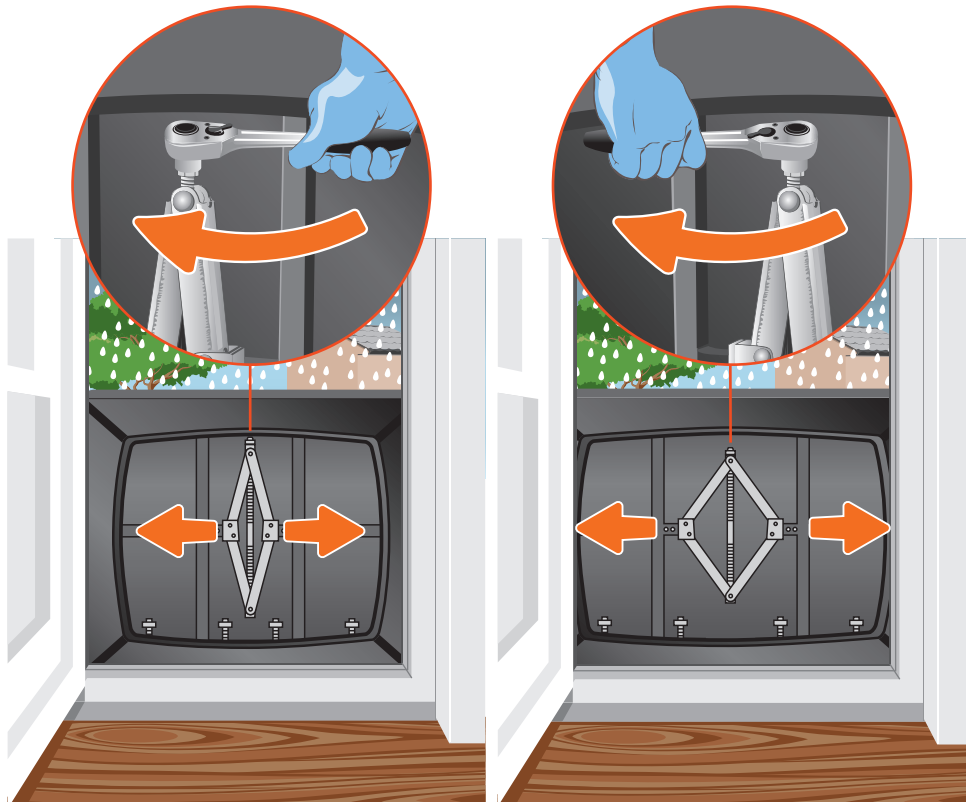

Using excessive force may result in damage to the product or doorway.

STEP 5

Starting with one of the downward pressure bolts located closest to the sides of the barrier, adjust downwards, with a clockwise action, firstly with your fingers and then with the 17mm spanner.

The bolt should be adjusted until it offers resistance and the cover has been compressed sufficiently to create a seal along the floor.

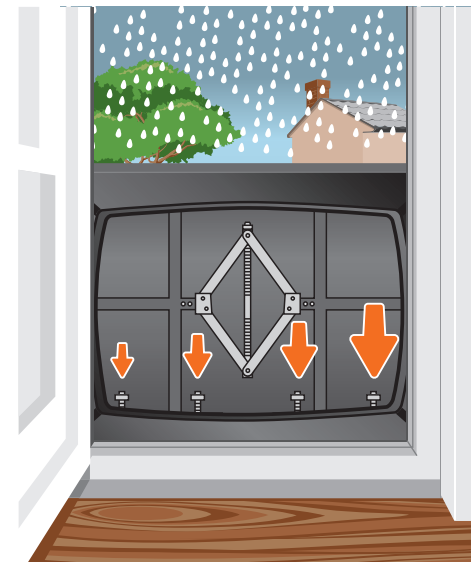
**STEP 6**

Repeat **STEP 5** for the remaining bolts until they have all been adjusted accordingly.

**STEP 7**

Further adjustment may be required to the operating mechanisms for example, if slight seepage occurs adjust the bolt closest to stem the flow.

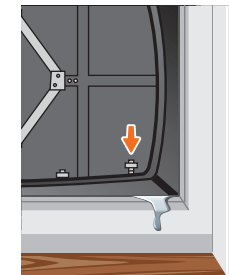

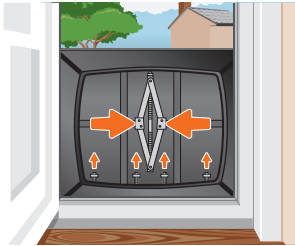

Once the flood threat has passed, counter turn the 4 downward pressure bolts and scissor jack, returning the barrier to its unexpanded state.

Remove the barrier from the doorway.

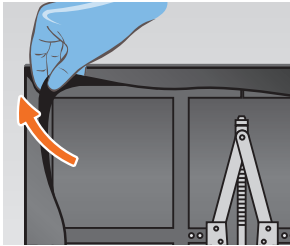

Carefully remove the cover and wipe clean with a damp cloth.

A hosepipe set at a low pressure, can be used to wash contamination from the cover or wash in a lukewarm water with a small amount of non biological detergent.

✗ Do not machine wash or tumble dry.



Dry in a shaded area, out of direct sunlight. Prior to storing, examine for potential damage. Repair or replace as necessary.

NOTE - some deformation of the cover may be seen after use. This is natural and the material will usually return to a normal state within a few days.

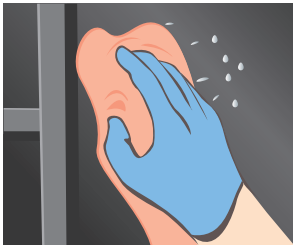

Remove excess moisture from the metal frame using a clean cloth. Examine for damage caused by stress, use or wear and tear, paying particular attention to the operating mechanisms.

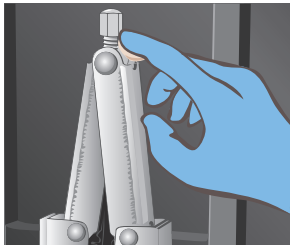

Apply marine grease (or similar) to all moving parts. Remove excess.

NOTE - you may need to open the barrier to grease the scissor jack and internal sliding parts. Fully retract after greasing so the cover can be easily placed over the frame when next needed.



All component parts of the Floodgate system should be stored in a cool, dry, well ventilated and secure environment, away from direct sunlight and temperature extremes.

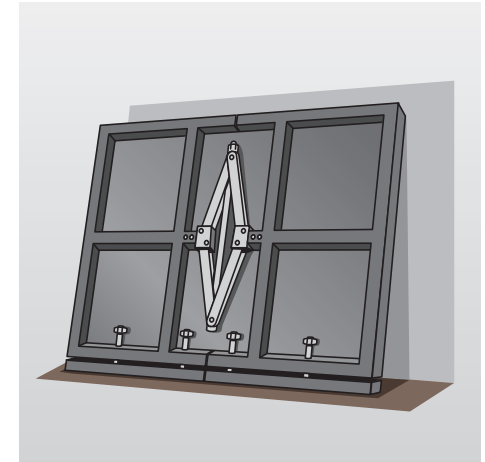
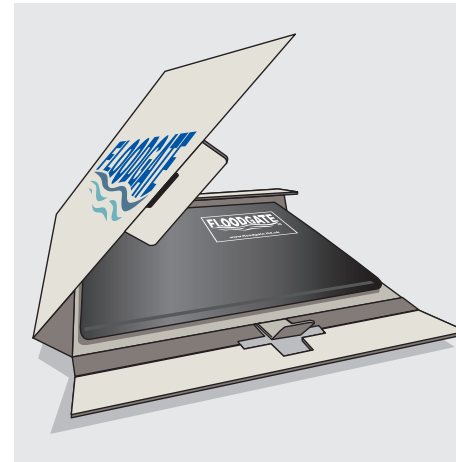

Once the cover is completely dry, lay flat in the original box. Cardboard inserts may be used to help the cover hold its shape. Store the box flat and off the ground to avoid accidental damage.



Store the steel frame in an upright position.



Periodically (and at least every 6 months of non use), examine the frame and cover to ensure they remain fit for purpose and operate correctly.

Troubleshooting

Problem	Possible Cause(s)	Solution
Spanner turns one way but not the other	Switch engaged in one direction	Toggle switch so that spanner operates in reverse direction
Barrier is stiff to open/close	Insufficient lubrication to operating mechanisms and/or internal sliding bars	Apply grease to operating mechanisms and internal sliding bars
Difficult to remove or place cover on the frame	Frame is in an expanded state	Ensure frame is fully closed and downward pressure bolts loosened prior to removing and reattaching cover

FAQ

What types of floodwater can a Floodgate be used in?	Floodgates can be used in fluvial (river), pluvial (rainfall) or saline (salt water) flood conditions. Floodgates should not be used to protect against hydrocarbon and solvent spills.
What type of wall and floor finishes can a Floodgate be used with?	Floodgates can be used with brick/blockwork, render, wood, uPVC and metal – as long as the surfaces are sufficiently strong to cope with the pressures exerted by the barrier.
How long does it take to deploy a Floodgate?	A Floodgate should take no more than 5 minutes to deploy meaning little or no warning is required.
Can I purchase replacement covers for my Floodgate?	Yes, new covers can be purchased from our online store - www.floodgate.ltd.uk/store
Can Floodgates be recycled?	All components of a life expired Floodgate frame can be recycled at a registered recycling centre. The covers require specialist recycling.

Floodgate has been independently tested against the standard set of tests as defined in BSI PAS 1188-1:2014 which represent typical conditions that might be experienced during a flood in the UK. This includes testing the product for leakage under static water levels 0.6m above aperture threshold level, waves up to 0.1m high and parallel currents up to 1.0m/s. The testing undertaken under this PAS excludes all other components of the flood protection system.

The maximum permitted leakage rate defined in BSI PAS 1188-1:2014 is 500mL/h/m. The maximum leakage rate during testing of Floodgate was recorded as 50mL/h/m at the designated maximum water depth (DMWD) of 0.6m.

Conformance of the product to BSI PAS 1188-1:2014 does not mean it is suitable for all buildings or locations. If the user has any uncertainty about the suitability of a product they should seek professional guidance.

Floodgate is intended for use on building apertures such as doorways or windows.

Floodgate can be used to protect domestic property, commercial premises, schools, hospitals, other public buildings and other categories of building.

Floodgate warrants that its Flood Barrier Kit will be free from defects in materials or workmanship on the date of shipment by Floodgate. Floodgate's exclusive obligations under this Warranty are as follows: if within 12 months from the date of purchase, Floodgate determines, upon inspection, that a Flood Barrier Kit was defective in materials and/or workmanship on the date of shipment, Floodgate will repair or replace any Kit that Floodgate determined was so defective. Whether repair or replacement is appropriate is a decision Floodgate shall make in its sole discretion.

Except for this Warranty, Floodgate makes no express warranties regarding its Flood Barrier Kit, does not guarantee the performance of this product, and specifically disclaims all implied warranties, including but not limited to the implied warranty of merchantability and the implied warranty of fitness for a particular purpose. No representative of Floodgate may change or alter this Warranty.

Exclusions From Warranty Coverage

Because Floodgate's Warranty is only against defects in materials or workmanship existing on the date of shipment by Floodgate, this Warranty does not apply in the following circumstances:

1. Floodgate's Flood Barrier Kit has been modified in any manner, installed in an improper manner, or improperly maintained; and/or
2. Floodgate's Flood Barrier Kit was damaged or mishandled after shipment by Floodgate, including but not limited to damage sustained as a result of repair not authorized by Floodgate.

It is important to follow Floodgate's fitting and maintenance instructions.

Warranty Service

Applications for repair or replacement of the purchase price for any Floodgate Flood Barrier Kit must be made to Floodgate in writing within 30 days of knowledge of any problem or alleged problem with the Floodgate product, and no later than 12 months from the date of purchase, at the following e-mail address: sales@floodgate.ltd.uk or the following street address: Floodgate Ltd, 49-51 Lammas Street, Carmarthen, Wales UK, SA31 3AL. Floodgate can also be reached by phone at 01267 234205, although all applications for warranty service must be in writing. If it is necessary for a Flood Barrier Kit to be returned to Floodgate for evaluation, the cost of shipping for such return is the responsibility of the user or owner of the Kit(s) in question.

Limitation of Liability

In no event shall Floodgate have any liability beyond repair or replacement as selected by Floodgate, whether in contract or tort or for breach of warranty, for damages or losses of any kind or nature directly or indirectly caused in whole or in part by Floodgate's Flood Barrier Kit, including but not limited to damages to property, damages for inconvenience or delay, damages for lost profits or business interruption, or direct, indirect, incidental, consequential, special, exemplary, or punitive damages. The limited remedies herein, which Floodgate has discretion to choose, are exclusive.

Choice of Law

Floodgate's Warranty shall be governed and construed under English law without giving effect to any principles of conflicts of law. Any claim by the purchaser or user of the product covered by Floodgate's Warranty, whether in contract or tort or for breach of warranty, shall be governed by English law, without giving effect to any principles of conflicts of law.